

The heavy-duty commercial chain operated clutch mechanism allows precise positioning of the Roller Shade. The bi-directional clutch never needs adjustment. When the operator stops pulling on the bead chain, the clutch stops automatically, holding the shade in the exact position desired.

Features:

- 1/8"-Thick Steel Bracket
- Clutch Fixed to Installation Bracket
- Fascia Valance does not require a notch to drop through
- #10 Qualified Stainless Steel Bead Chain may be offset
- Idler End Bracket has a height-leveling adjustment
- Idler End Bracket has a ball bearing idler for quiet and ultra-smooth rotation
- Idler End Bracket available as wall or ceiling mount (must specify)
- Idler End Cap is spring-loaded and retractable for simple and easy installation
- Manufactured from PA6/glass fiber

Shade Dimensions:

- Minimum Width — 8"
- Maximum Width — 108"
- Minimum Height — 8"
- Maximum Height — 144"

Over-sized Shade Option:

- 2 1/2" Steel Tube with Platinum Series Clutch and Spring Assist.

Maximum width: 162"
Maximum length: 108"

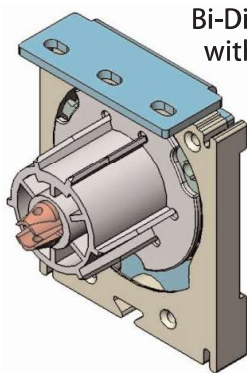
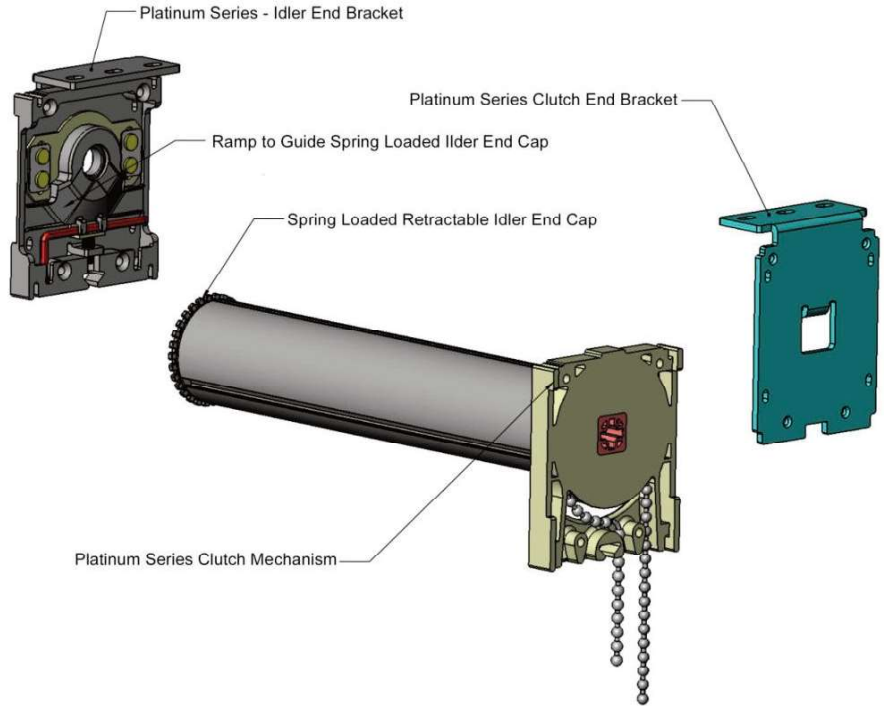

**Bi-Directional Clutch
with Fixed Bracket**

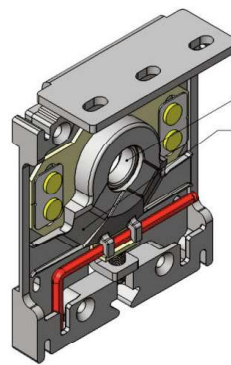

**LEVEL CORRECT
BRACKET™**

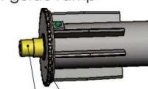

teathed rotate wheel
10mm shaft: spring loaded, retractable

Bracket Dimensions:

Ceiling Mount Installation	
Projection	3"
Height	3 3/4"

Wall Mount Installation	
Projection	3 1/4"
Height	3 3/4"

